



British Audio



80.8-10 • 1600 Watts • Class D • 8 Channel DSP Amplifier

DSP
DIGITAL SIGNAL PROCESSOR

POWERBOX80.6-8 DSP

- POWERBOX80.6-8DSP-V3

POWERBOX80.8-10 DSP

- POWERBOX80.8-10DSP-V3



Download on the
App Store



GET IT ON
Google Play

Power box

DSP
DIGITAL SIGNAL PROCESSOR

Owners Manual

Congratulations on purchasing your VIBE amplifier. Please read this manual in order to fully understand how to get the best results from this product and ensure that all advice on how to look after the product is followed.

Thank you for buying VIBE, we hope you enjoy listening to your product as much as we enjoyed creating it.

Attention



An aftermarket audio amplifier will place an additional load on the vehicles charging system.

Most modern vehicles have sufficient capacity in the charging system as not all the electrical components of the vehicle will be switched on at once.

Check the fuse rating of the amplifier and use this as the peak current requirement.

Generally the continuous current draw will be a third of the peak current.

Warning

During the normal use of this amplifier the heatsink may become very hot.

Please do not touch during or immediately after use.

Please ensure that when installing this product the heatsink will not come into contact with any materials that may be damaged by heat such as upholstery or plastics.

UK Technical Enquiries

Call 09067031420

Calls cost 50p per minute. Call costs correct at date of publication (01/02/12)

Hours of business 9.00am - 5.30pm GMT Monday - Friday.

All calls are recorded for training purposes.

MIDBASS Distribution

PO Box 11000

B75 7WG

International Technical Enquiries

For international technical support please contact the distribution agent for your country.

Please visit **www.vibeaudio.co.uk/contact** for more details.

Limited Warranty

All VIBE products carry a full 12 month warranty, valid from the date of the original receipt and proof of purchase. The online warranty card should be completed within seven days of the original purchase date. The original receipt and packaging should be retained for this twelve month period. If the product develops a problem any stage during the warranty period, it should be returned to the point of purchase in its original packaging, and complete with no items missing. If the store is unable to repair the product it may have to be returned to VIBE.

A full description of VIBE's warranty information can be found on our website:

www.vibeaudio.co.uk

What Is Not Covered

- Damage to product due to improper installation.
- Subsequent damage to other components.
- Damage caused by exposure to moisture, excessive heat, chemical cleaners and / or UV radiation.
- Damage through negligence, misuse, accident or abuse. Repeated returns for the same fault may be considered abuse.
- Any cost or expense related to the removal and / or re-installation of the product.
- Damage caused by amplifier clipping or distortion.
- Items repaired or modified by any unauthorised repair facility.
- Return shipping on non defective items.
- Products returned without a returns authorisation number.
- Damage to product due to use of sealant.

International Warranty

Contact your international VIBE dealer or distributor concerning specific procedure for your country's warranty policies. www.vibeaudio.co.uk/warranty

Warning

VIBE equipment is capable of sound pressure levels that can cause permanent damage to your hearing and those around you. Please use common sense when listening to your audio system and practice safe sound.

Copyright

All content included in this manual such as text, graphics, logos, icons, images and data, are the property of Midbass Distribution Limited t/a VIBE Technologies Limited (herein referred to as "VIBE", "us" or "we") and its affiliate or their content and technology providers, and are protected by United Kingdom and International copyright laws. All rights reserved. VIBE TV, VIBE Arcade, Bass Box, Optisound, Cinesound, BlackAir, BlackBox, Space, LiteAir, SLICK, BlackDeath, Bubonic, Reaper, Anti-VIBE, FastPlug, BlackHole, QB69, VIBE Turbo Port, Vibe TurboVent, Pressure Board, Super Driver, VIBE Pulse, VIBE Power, VIBE Digital, VIBE MAG Plugs, Ferrite Loaded, VIBE Solid Core, VIBE OCC, VIBE FLAT, ICC, Bass Enhance, Bass Enhance+, QBass, SpeedBass, PowerBass, N-Wedge, Box Grip, ARBSS, Supercar Series and all stylised representations of product names, or the abbreviations of product names, as logos are all trademarks of VIBE. Graphics and logos are trademarks or trade dress of VIBE Technologies Ltd or its subsidiaries. VIBE's trademarks and trade dress may not be used in connection with any product or service that is not VIBE's, in any manner that is likely to cause confusion among customers or in any manner that disparages or discredits VIBE. All other trademarks not owned by VIBE or its subsidiaries that appear in this manual are the property of their respective owners, who may or may not be affiliated with, connected to, or sponsored by VIBE or its subsidiaries.

TO THE FULLEST EXTENT PERMITTED AT LAW, VIBE IS PROVIDING THIS MANUAL AND ITS CONTENT ON AN "AS IS" BASIS AND MAKES NO (AND EXPRESSLY DISCLAIMS ALL) REPRESENTATIONS OR WARRANTIES OF ANY KIND, EXPRESS OR IMPLIED, WITH RESPECT TO THIS MANUAL OR THE INFORMATION, CONTENT, MATERIALS OR PRODUCTS INCLUDED IN THIS MANUAL INCLUDING, WITHOUT LIMITATION, WARRANTIES OF MERCHANTABILITY AND FITNESS FOR A PARTICULAR PURPOSE. IN ADDITION, VIBE DOES NOT REPRESENT OR WARRANT THAT THE INFORMATION CONTAINED IN THIS MANUAL IS COMPLETE OR CURRENT, AND THAT ALL SPECIFICATIONS AND INFORMATION CONTAINED WITHIN THIS MANUAL ARE SUBJECT TO CHANGE WITHOUT NOTICE. VIBE RECOMMENDS CAUTION WHEN LISTENING TO MUSIC REPRODUCED THROUGH VIBE EQUIPMENT. VIBE EQUIPMENT IS CAPABLE OF PRODUCING SOUND AND SOUND PRESSURE LEVELS THAT CAN PERMANENTLY DAMAGE HEARING OF YOU AND THAT OF OTHERS. FOR SAFE AND ENJOYABLE LISTENING, THE SOUND SHOULD BE CLEAR WITHOUT DISTORTION AT A COMFORTABLE VOLUME. BY USING ANY VIBE EQUIPMENT, YOU AGREE TO TAKE FULL RESPONSIBILITY FOR YOUR OWN SAFETY AND THE SAFETY OF OTHERS WHEN LISTENING TO MUSIC AT HIGH VOLUMES THROUGH EQUIPMENT YOU HAVE PURCHASED. USE OF ANY VIBE EQUIPMENT CONSTITUTES AGREEMENT TO THIS DISCLAIMER. Except as specifically stated in this manual, to the fullest extent permitted at law, neither VIBE nor any of its affiliates, directors, employees or other representatives will be liable for damages arising out of or in connection with the use of this manual or the information, content, materials or products included. This is a comprehensive limitation of liability that applies to all damages of any kind, including (without limitation) compensatory, direct, indirect or consequential damages, loss of data, income or profit, loss of or damage to property and claims of third parties. For the avoidance of doubt, VIBE does not limit its liability for death or personal injury to the extent only that it arises as a result of negligence of VIBE, its affiliates, directors, employees or other representatives.

Mounting Guidelines

Your VIBE amplifier is designed with a swift installation routine in mind.

Please mount the amplifier in a dry location on a solid surface.

NEVER mount the amplifier upside down as this will cause the amplifier to over heat and will eventually damage the amplifier.

Before fixing the amplifier in place please ensure that there is sufficient air flow around the exterior of the casing, at least two inches is sufficient to allow effective cooling.

Power Connections

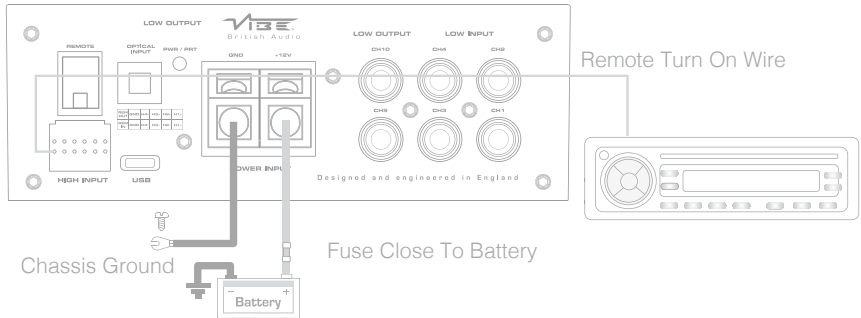

Low Level Input

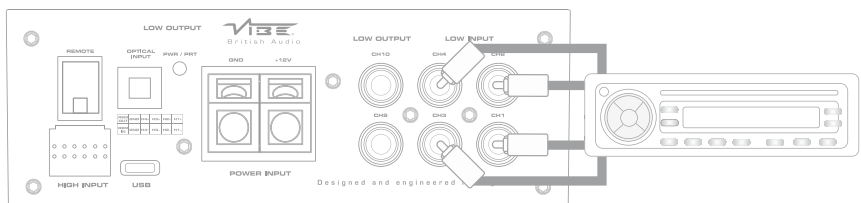

High Level Input

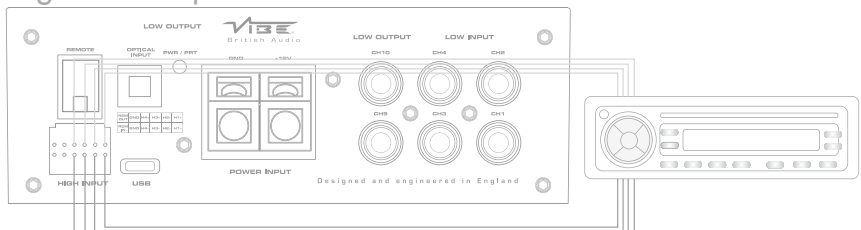

NOTE : When using high level input it is not necessary to connect the remote turn on wire. Do not connect both high level and low level input at the same time.

Power Cable

- At least 8 gauge cable should be used for the power connection to the amplifier with 4awg being the recommended cable gauge. .
- The power cable should be taken directly from the battery. Rubber grommets should be used when passing through any bulkheads to prevent the cable from becoming chaffed or cut.
- It is vital that a fuse / circuit breaker (of at least equal value to the one fitted in the amplifier) is placed inline with the power cable and is no further than 18 inches away from the battery.
- Please ensure that the fuse is not fitted until the entire installation procedure is complete.

Ground Cable

- At least 8 gauge cable should be used for the ground connection to the amplifier with 4awg being the recommended cable gauge.
- The amplifier ground should be connected directly to the chassis of the vehicle, to bare metal.
- The cable length should be kept to an absolute minimum.
- It is not recommended that you connect the ground cable to the vehicles seatbelts anchor point.

Auto Turn On (High level Input Only)

- The PowerBox amplifiers feature an auto turn on circuit called Autosense.
- This circuit allows the amplifier to switch on and off without a remote turn on wire when using high level input, for low level input (RCA) it will still be necessary to connect the remote turn on wire from the headunit.
- When the connected source (headunit) is turned on the amplifier will turn on automatically, after the connected source (headunit) is turned off the amplifier will shut down.

RCA Cables

- Depending on the model of your headunit and the number of speakers you wish to power you will have to run either one, two or three RCA cables from the source to the amplifier.
- Please take extra care when running these cables from the source to the amplifier. Ensure that they are placed away from all items that can generate any interference, wiring harnesses etc.
- It is recommended that the RCA cables should be run on opposite sides of the car to the previously installed power cables if possible, to avoid the cable picking up interference.

Terminals And Connections

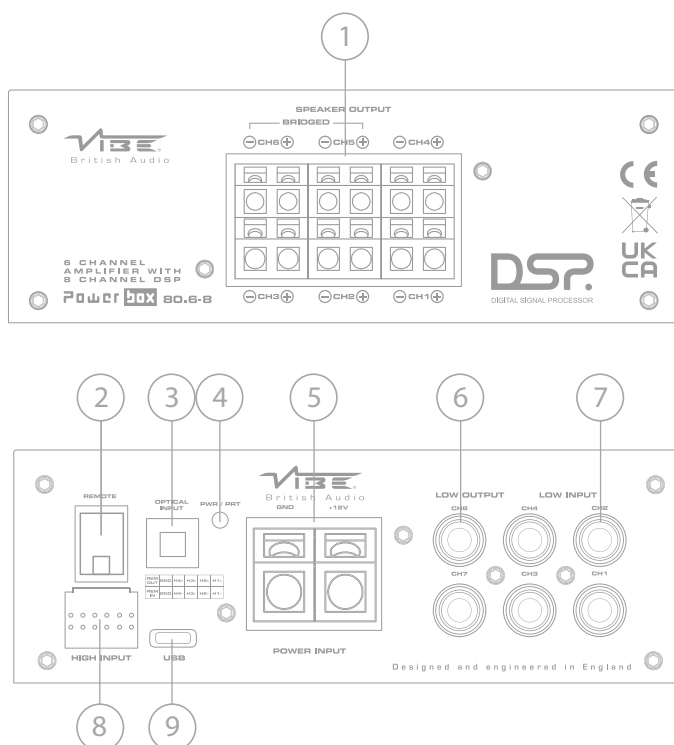

1. Speaker terminals

Used to connect speaker cables to the amplifier. See the wiring configuration section for more details.

2. Remote input socket

Used to connect the optional remote control.

3. Optical digital input

For connection to a source with TOSLINK optical digital output.

4. Power / protect LED

If the amplifier is operating normally, the LED will illuminate GREEN.

If the amplifier is in protection mode the LED will illuminate RED.

5. Power terminals

Used to connect DC power to the amplifier. See the power connections section for more details

6. CH7 / CH8 low level output

For connection to an additional amplifier or processor.

7. Low level input

For connection to any source (head unit) with a low level output to the rear channels of the amplifier. This is your RCA output from the source (headunit).

8. High level input

For connection to the speaker output of your source (head unit). This is to be used if the source (headunit) does not have a low level output.

9. USB connection

Used to connect the amplifier to a PC.

6 Channel Wiring Configuration

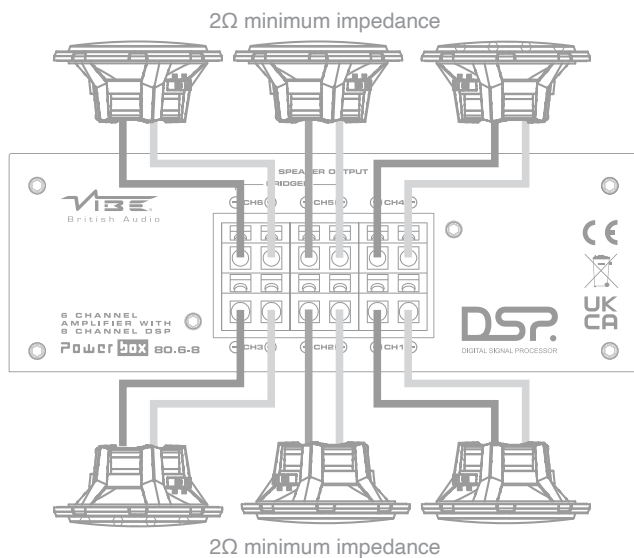

5 Channel Wiring Configuration

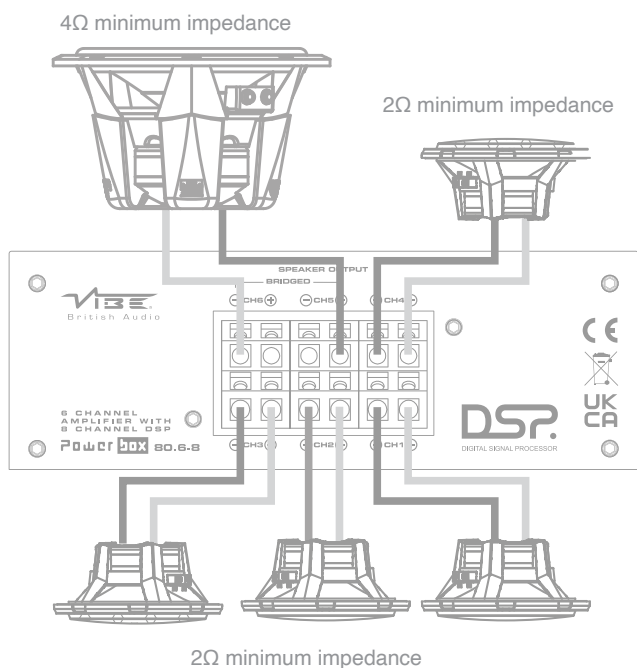

NOTE : Only Channels 5 and 6 can be bridged.

Terminals And Connections

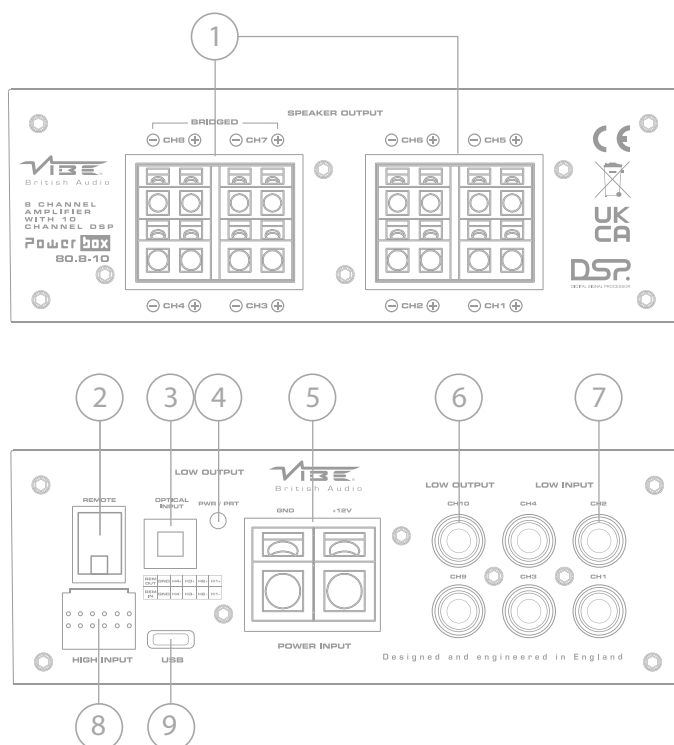

1. Speaker terminals

Used to connect speaker cables to the amplifier. See the wiring configuration section for more details.

2. Remote input socket

Used to connect the optional remote control.

3. Optical digital input

For connection to a source with TOSLINK optical digital output.

4. Power / protect LED

If the amplifier is operating normally, the LED will illuminate GREEN.

If the amplifier is in protection mode the LED will illuminate RED.

5. Power terminals

Used to connect DC power to the amplifier. See the power connections section for more details

6. CH7 / CH8 low level output

For connection to an additional amplifier or processor.

7. Low level input

For connection to any source (head unit) with a low level output to the rear channels of the amplifier. This is your RCA output from the source (headunit).

8. High level input

For connection to the speaker output of your source (head unit). This is to be used if the source (headunit) does not have a low level output.

9. USB connection

Used to connect the amplifier to a PC.

8 Channel Wiring Configuration

2Ω minimum impedance

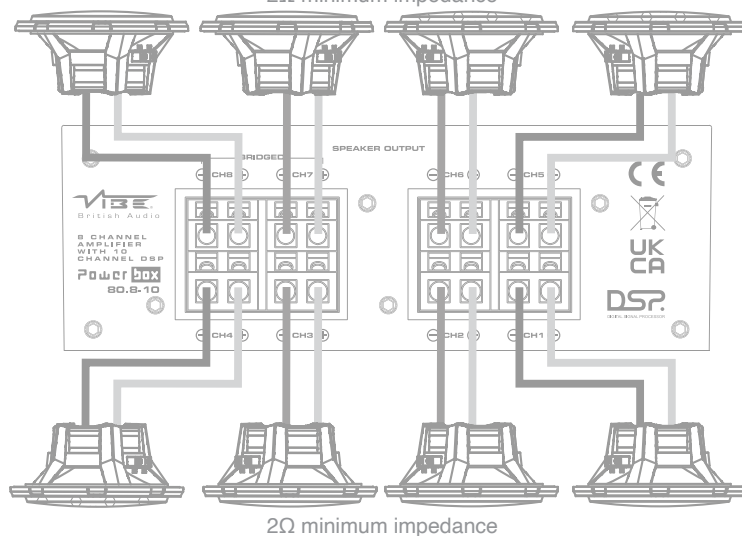

7 Channel Wiring Configuration

4Ω minimum impedance

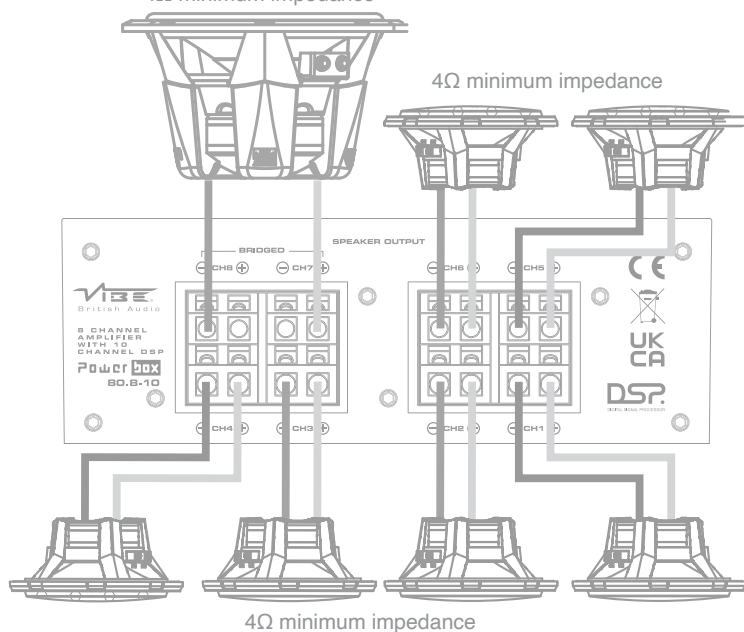

NOTE : Only Channels 7 and 8 can be bridged.

Set Up Section

The POWERBOX DSP amplifiers are designed to be set up with a smartphone app.



Features include :

- 1/3 Octave 31 band parametric equaliser with variable Q factor.
- Channel time alignment.
- LP / BP / HP / crossover with adjustable slope and alignment.
- Master volume control.
- Input source select.
- User defined presets.
- Phase adjust.
- Channel mixer
- Audio compressor

Please ensure that you download the appropriate app for your smartphone's operating system.



Download on the
App Store



GET IT ON
Google Play

Setup Application Video Guide

Please visit the VIBE website for a full guide on the operation of the setup app.

POWERBOX80.6-8DSP-V3



www.vibeaudio.co.uk

POWERBOX80.8-10DSP-V3



Specification

Model	POWERBOX80.6-8DSP-V3	POWERBOX80.8-10DSP-V3
Configuration	6 channel + 2 channel preout	8 channel + 2 channel preout
Dimensions (H x W x D)	40 x 220 x 131mm	40 x 220 x 131mm
RMS @ 4Ω stereo	6 x 80 watts	8 x 80 watts
RMS @ 2Ω stereo	6 x 100 watts	8 x 100 watts
RMS @ 4Ω stereo + bridged	4 x 80 +1 x 200 watts	6 x 80 +1 x 200 watts
Maximum Power	1200 watts	1600 watts
Frequency Response	20Hz - 20kHz	20Hz - 20kHz
S/NR	102dB	102dB
Crossover Type	LP / HP / BP / Flat	LP / HP / BP / Flat
Crossover Range	20Hz - 20kHz	20Hz - 20kHz
Operating Voltage	9.6v ~ 18v	9.6v ~ 18v
Recommended fuse rating	60A	80A

Connect Bluetooth Audio

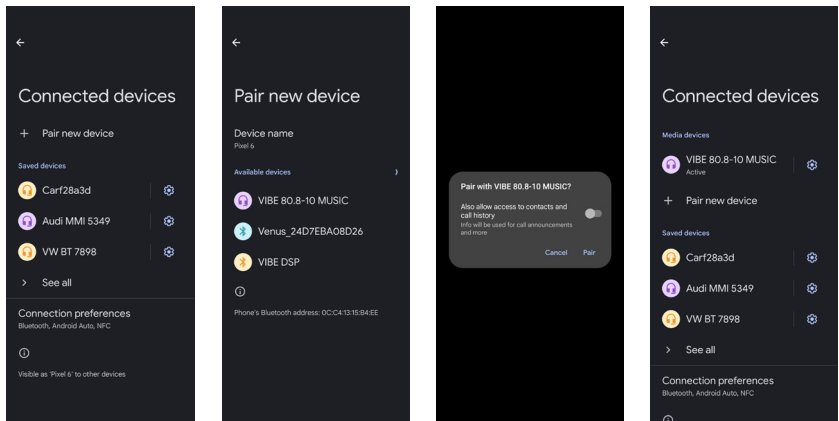

1. Search for new device.
2. Select VIBE 80 MUSIC.
3. Confirm pairing.

Connect Smartphone To App



1. Open VIBE DSP app and press DSP button.
2. Select VIBE DSP.
3. App will connect and read settings from the DSP.

Master Volume



1. Swipe with finger to control master volume rotary dial.

Assignable Channel Volume

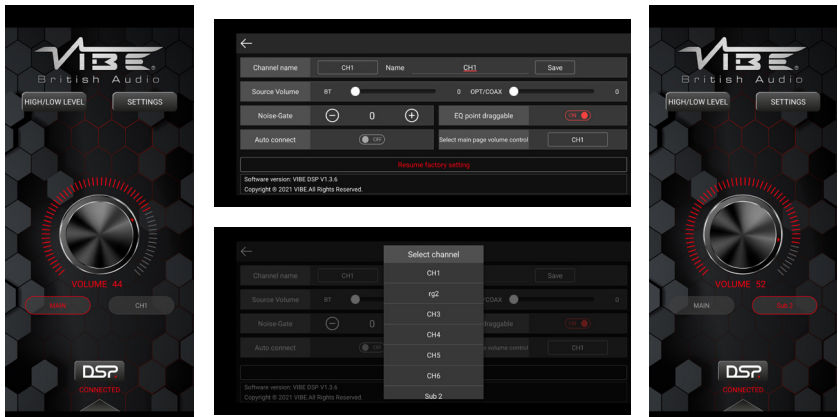

1. Select channel volume button.
2. To assign the channel go to settings.
3. Select the channel you wish to assign.
4. Channel has now updated in main menu.

Audio Input



1. Select desired audio input.
2. Here we've chosen bluetooth as an example.

Preset Menu



1. Press arrow to bring up presets and select preset to be customised.
2. Make desired adjustments.
3. Press save / load.

Preset Menu (Cont)

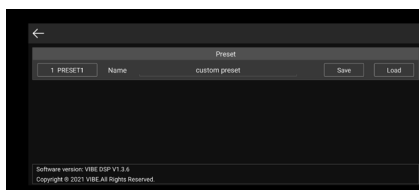
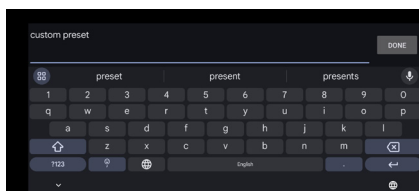

4. Rename preset if desired.
5. Press save.

Preset Lock

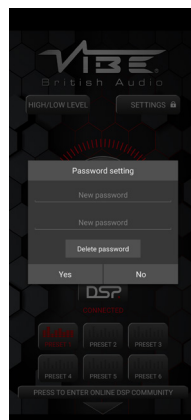
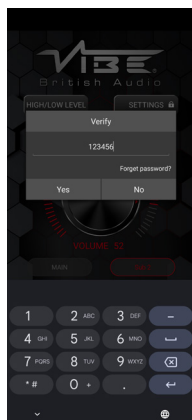
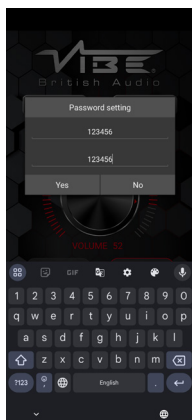
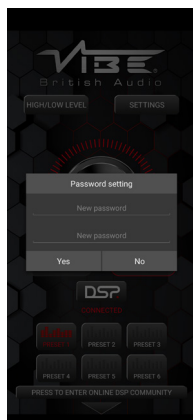

1. Hold down preset to bring up passcode menu.
2. Enter desired six digit numerical passcode followed by yes.
Note that settings now has a lock icon.
3. Hold down preset again to access menu.
4. Input passcode.
5. The passcode can be changed or deleted.

Settings Menu

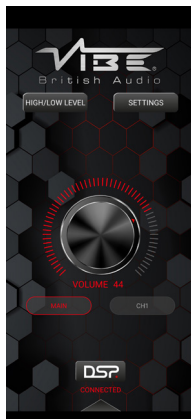

1. Press settings button to enter main setup.

Channel Selection



1. Select desired channel for adjustment.

Crossover Setup

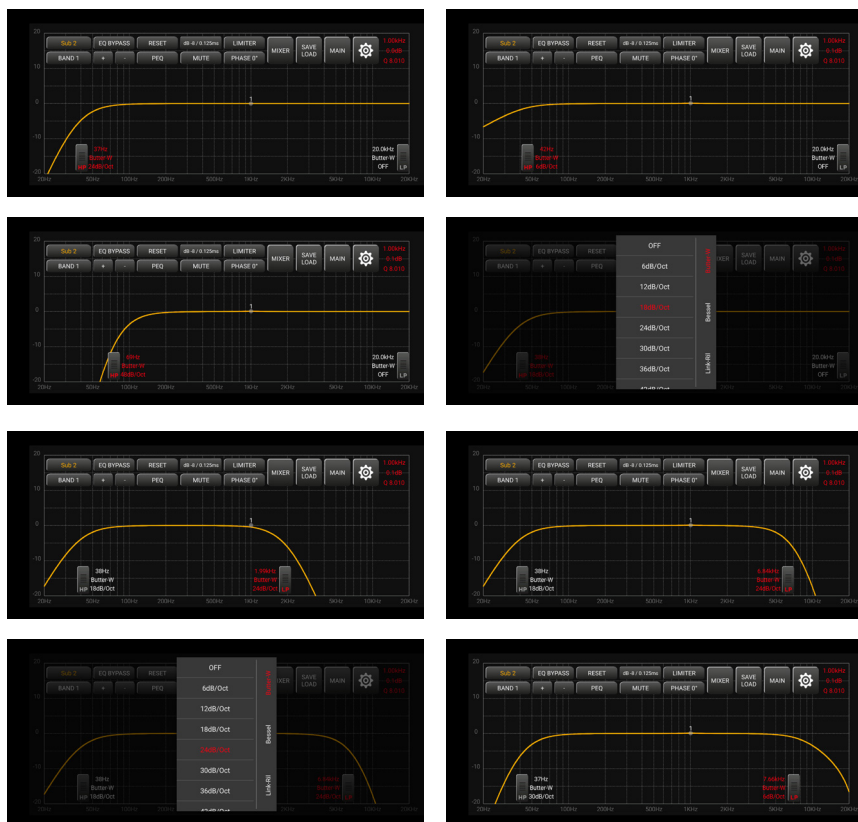

1. Swipe bottom left button to set high pass.
2. Swipe up and down to select slope.
3. Swipe away from button for fine adjustment.
4. Click text to select slope and alignment.
5. Swipe bottom left button to set low pass.
6. Swipe up and down to select slope.
7. Click text to select slope and alignment.
8. Swipe away from button for fine adjustment.

Equaliser Setup

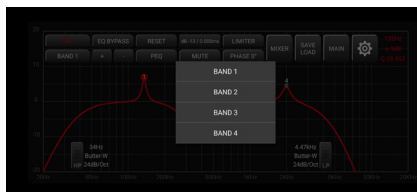
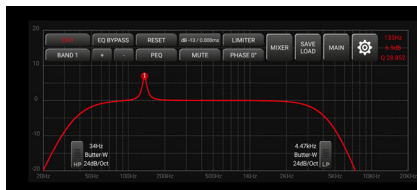

1. Press band to adjust frequency and gain.
2. Press, hold and swipe button to adjust frequency and gain.
3. Swipe away from button for fine adjustment.
4. Pinch in and out to adjust frequency q factor.
5. Press + button to add more eq points (max 31).
6. Press - button to delete eq points.
7. Press band button to change selected band.
8. Double press away from button to reset point.

EQ Bypass

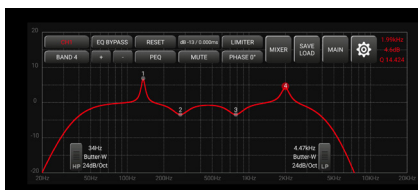

1. Press eq bypass to turn off equaliser.
2. Other settings can still be adjusted.
3. Press eq bypass again to turn on equaliser.

Reset

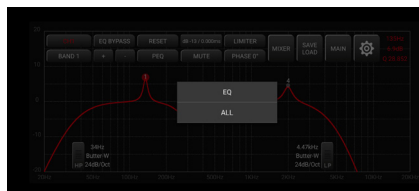

1. Reset EQ resets only equaliser settings.
2. Reset all resets both EQ and x-over settings.

Channel Mute



1. Press mute to mute selected channel.
2. Press mute again to unmute selected channel.

Channel Gain / Delay

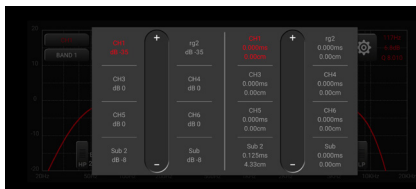
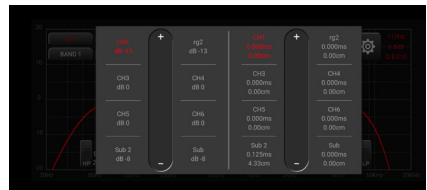

1. Press db/ms to bring up gain / time menu.
2. Swipe up and down to adjust gain and delay.
3. All channels are available for adjustment.

Limiter

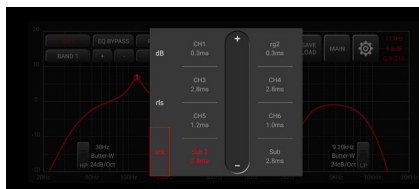
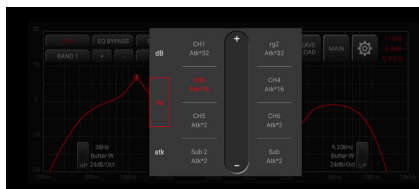
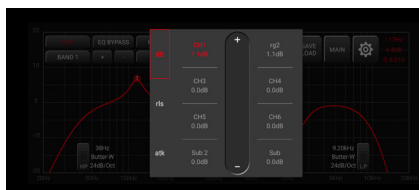

1. Press limiter to bring up compressor menu.
2. Swipe up and down to set compression level.
3. Select rls (release) to set speed of effect end.
4. Select atk (attack) to set speed of effect start.

Phase



1. Press phase button to toggle between 0° and 180°.

Mixer Channel Linking

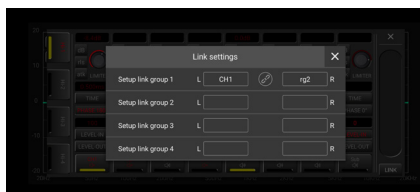
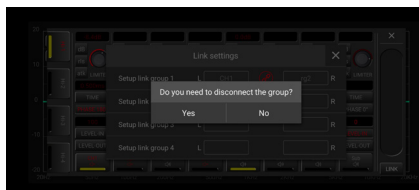
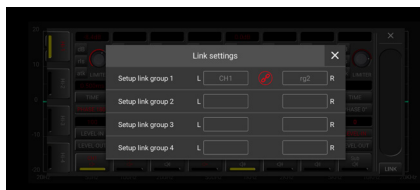
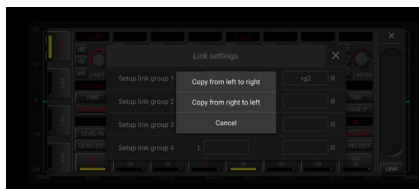
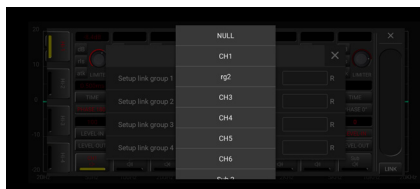
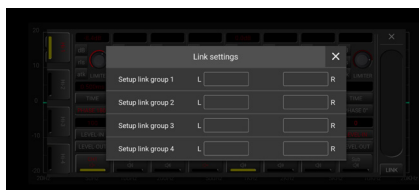

1. Channels can be linked in mixer.
2. Press link button to bring up link panel.
3. Select channels to be linked
4. Press link icon
5. Select desired link configuration.
6. Channels are now linked.
7. To unlink click link icon and confirm.
8. Channels are still available for linking

Mixer Additional Features



1. Phase can be adjusted.
2. Time can be adjusted.
3. Limiter can be adjusted.
4. All channels can be muted.
5. Rename channels directly in mixer.
6. Hold down channel button to rename.
7. Channel name is updated in main settings.

Rename Channels

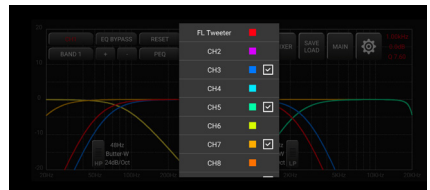
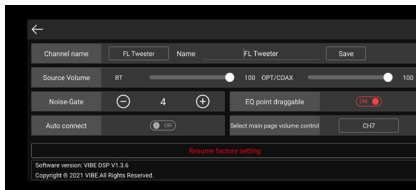
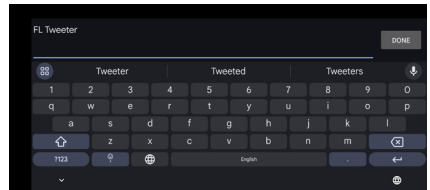
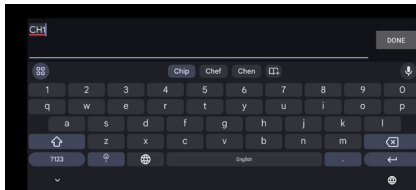
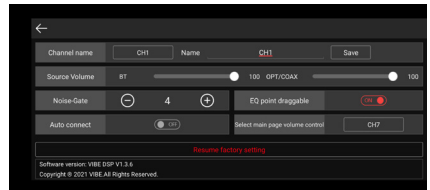
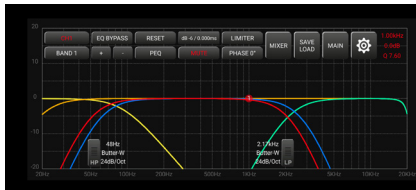

1. Press settings cog.
2. Select channel to rename.
3. Press to rename channel.
4. Type new channel name.
5. Press save.
6. Channel name is updated in main settings.

BT / Digital Gain

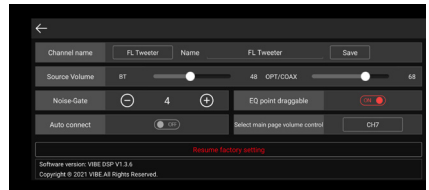
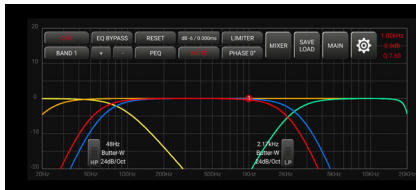

1. Press settings cog.
2. Swipe to adjust level.

Noise Gate

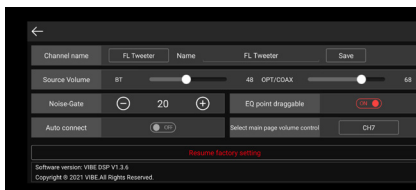
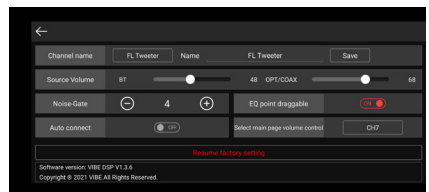
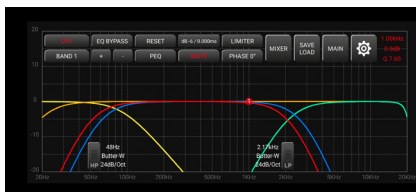

1. Press settings cog.
2. Increase noise gate to desired level.
3. Higher numbers make effect take place faster.

Auto Connect

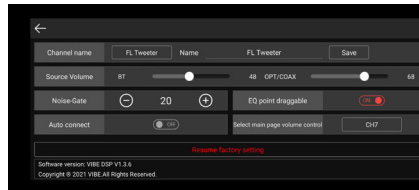
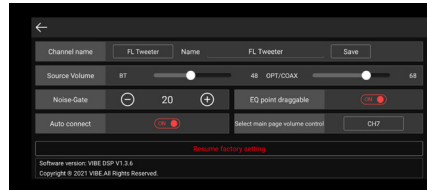

1. Press settings cog.
2. Click auto connect button to toggle on / off.
3. This is necessary in multi dsp systems.

UK Technical Enquiries

Call 09067031420

Calls cost 50p per minute. Call costs correct at date of publication (01/02/12)

Hours of business 9.00am - 5.30pm GMT
Monday - Friday.

All calls are recorded for training purposes.

MIDBASS Distribution

PO Box 11000

B75 7WG

International Technical Enquiries

For international technical support please contact the distribution agent for your country.

Please visit

www.vibeaudio.co.uk/contact

for more details.



Designed and engineered in England



www.vibeaudio.co.uk

www.youtube.com/vibeaudio

www.facebook.com/vibeaudio

www.instagram.com/vibeaudio

